

RAPIDCUT - 8

TECHNICAL FEATURES

POWER SUPPLY.....Filtered, lubricated air
 CONSUMPTION.....7 Lt./cut at 6.5 bar
 MAXIMUM ϕ CUT.....8 ϕ (Steel up to 70 Kg./mm²)
 5 ϕ (Steel up to 180 Kg./mm²)
 SPEED.....60 Cuts/minute
 MAXIMUM PRESSURE.....8.5 bar
 MINIMUM PRESSURE.....6 bar
 WEIGHT.....5.8Kg.

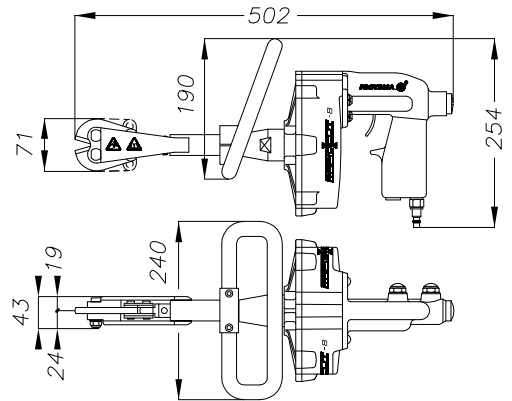

RAPIDCUT - 8L

TECHNICAL FEATURES

POWER SUPPLY.....Filtered, lubricated air
 CONSUMPTION.....7 Lt./cut at 6.5 bar
 MAXIMUM ϕ CUT.....8 ϕ (Steel up to 70 Kg./mm²)
 5 ϕ (Steel up to 180 Kg./mm²)
 SPEED.....60 Cuts/minute
 MAXIMUM PRESSURE.....8.5 bar
 MINIMUM PRESSURE.....6 bar
 WEIGHT.....7.2Kg.

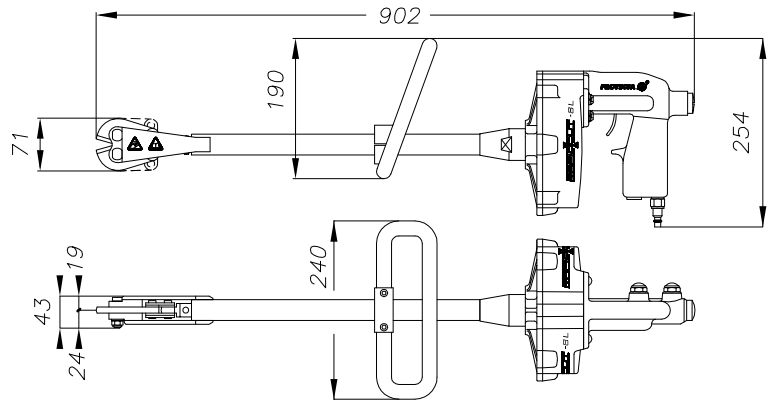

RAPIDCUT - 8XL

TECHNICAL FEATURES

POWER SUPPLY.....Filtered, lubricated air
 CONSUMPTION.....7 Lt./cut at 6.5 bar
 MAXIMUM ϕ CUT.....8 ϕ (Steel up to 70 Kg./mm²)
 5 ϕ (Steel up to 180 Kg./mm²)
 SPEED.....60 Cuts/minute
 MAXIMUM PRESSURE.....8.5 bar
 MINIMUM PRESSURE.....6 bar
 WEIGHT.....8.7Kg.

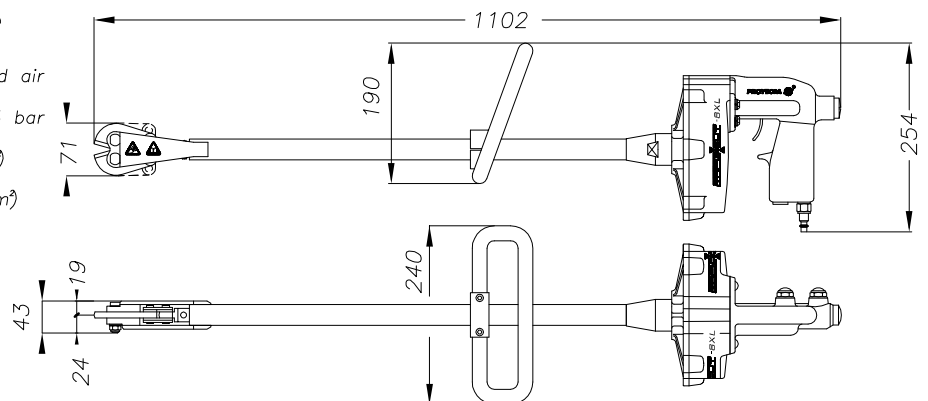

APPROPRIATE BLADE TYPE

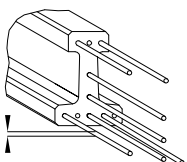

MAX. 5 ϕ
 ref. M80L
 High tensile wire
 Up to 180 Kg./mm²

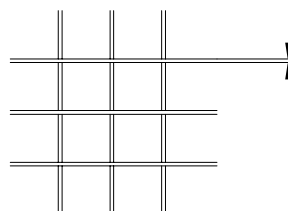

MAX. 8 ϕ
 ref. M60L
 Rebar and wire mesh
 Up to 70 Kg./mm²